



GEOPRO 3.14

Bureau de Géomètres-Experts, Urbanisme et Aménagement du territoire

Siège social
Klosterstraße 12 B-4780 ST.VITH
Tél. : +32 (0)80 22 66 86
Fax : +32 (0)80 22 66 96

Siège d'exploitation
Rue Fond Cattelain 2 B-1435 MONT-ST-GUIBERT
Tél : +32 (0)10 28 04 13
Fax : +32 (0)10 28 04 15

E-mail : info@geo314.eu | Web Site : www.GEO314.eu

Plan d'ensemble du lotissement " Rue de la Station " à Sart-Lez-Spa (Ref. Urb.: 63038-LTS-0311-00)

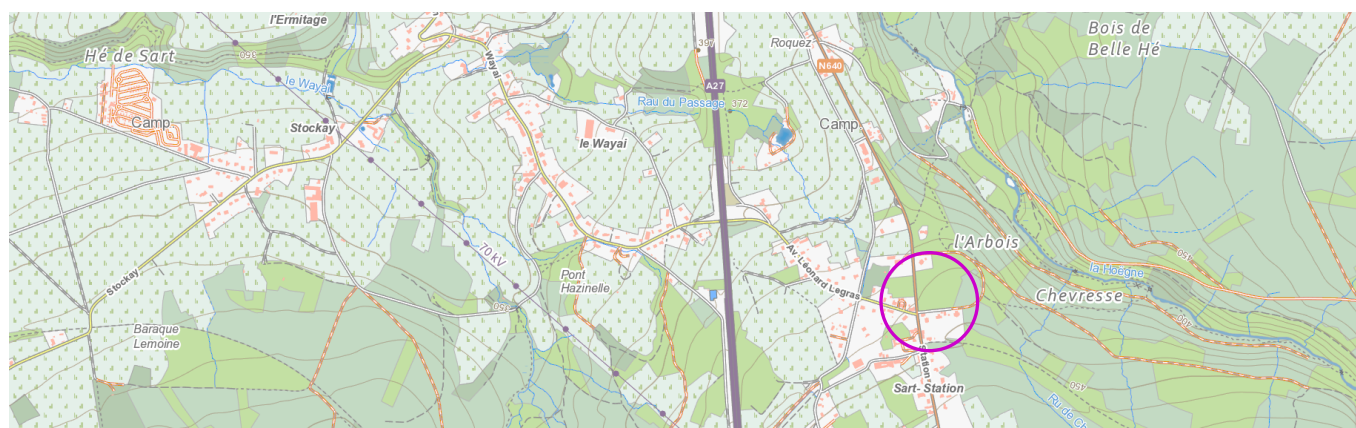

COMMUNE : JALHAY
DIVISION : 2 - Sart
Section : B - " Rue de la Station "
Parcelle : 2907M23

Système de coordonnées : Coordonnées locales

Sources : Cadastre et Situation

Matérialisation : Aucune

Date : 20/02/2024

Dossier : 224013-ENS-1 ind. A

Echelle : 1/500

Jean-François LEMPEREZ













Ingénieur industriel en construction, option géomètre assermenté auprès du Tribunal de 1^{ère} instance de Verviers le 28 Avril 1999. Inscrit sur la liste des géomètres-experts sous l'identification GEO060972

(Page : 1/2)



DA09-23
EC V6 04/04/2022





LEGENDE

-  clôture
-  bord sentier
-  haut talus
-  bas talus
-  bord voirie
-  axe voirie
-  limite cadastrale
-  nouvelle limite
-  plan masse : 212062-MAS-1 ind C
-  repère non matérialisé
-  rangée d'arbres
-  haie
-  asphalte

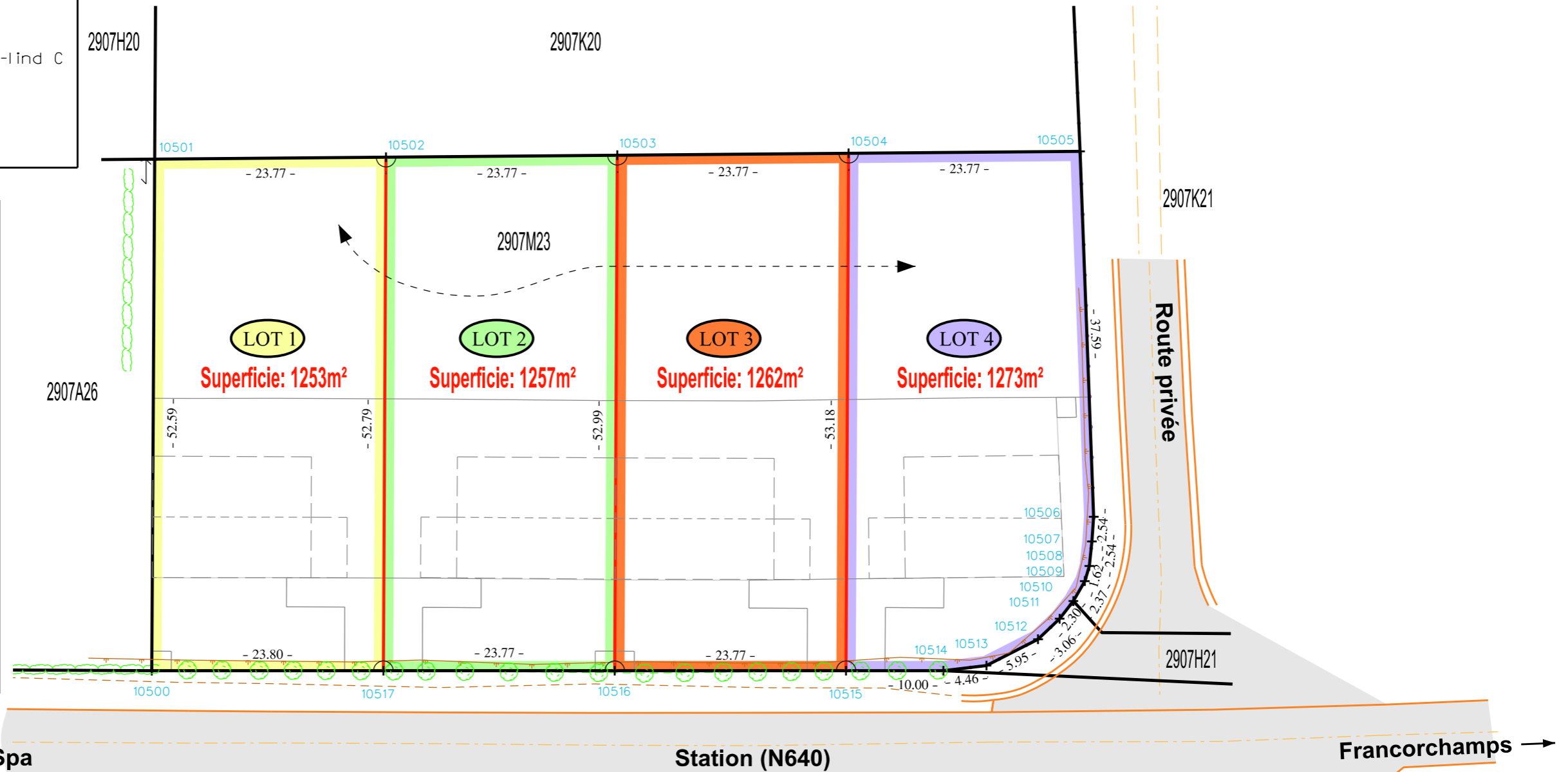

Point	X (m)	Y (m)
10500	1000,00	1000,00
10501	1000,29	1052,59
10502	1024,07	1052,79
10503	1047,84	1052,99
10504	1071,61	1053,18
10505	1095,37	1053,38
10506	1096,78	1015,82
10507	1096,60	1013,29
10508	1096,34	1010,76
10509	1095,87	1009,21
10510	1094,69	1007,15
10511	1093,28	1005,34
10512	1091,06	1003,23
10513	1085,76	1000,53
10514	1081,34	1000,00
10515	1071,34	1000,00
10516	1047,57	1000,00
10517	1023,80	1000,00



-  LOT 1 en jaune, superficie: 1253m² de 2907M23
-  LOT 2 en vert, superficie: 1257m² de 2907M23
-  LOT 3 en orange, superficie: 1262m² de 2907M23
-  LOT 4 en mauve, superficie: 1273m² de 2907M23