

Vermeulenstraat 58 Lokeren_Grondplannen

li.HUISPUNT

TOTAL AREA: 208.12 m² • LIVING AREA: 208.12 m² • FLOORS: 3 • ROOMS: 22

▼ Ground Floor

TOTAL AREA: 115.51 m² • LIVING AREA: 115.51 m² • ROOMS: 13

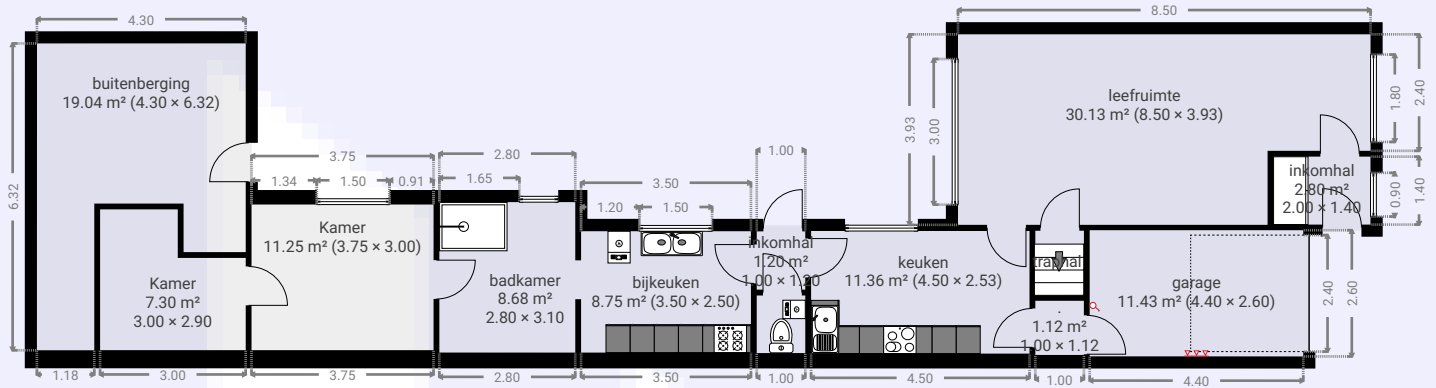

▼ 1st Floor

TOTAL AREA: 49.31 m² • LIVING AREA: 49.31 m² • ROOMS: 6

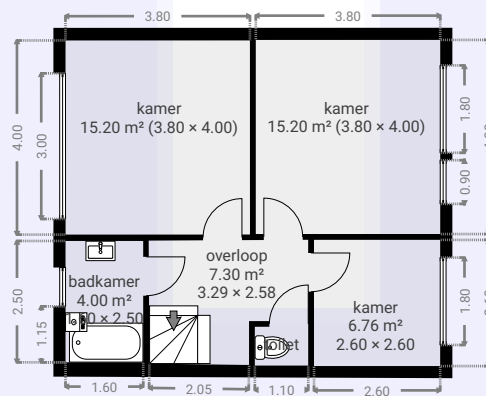

THIS FLOORPLAN IS PROVIDED WITHOUT WARRANTY OF ANY KIND. SENSOPIA DISCLAIMS ANY WARRANTY INCLUDING, WITHOUT LIMITATION, SATISFACTORY QUALITY OR ACCURACY OF DIMENSIONS.

0 2 4 6m 1:156

Page 1/2

Vermeulenstraat 58 Lokeren_Grondplannen

li.HUISPUNT

TOTAL AREA: 208.12 m² • LIVING AREA: 208.12 m² • FLOORS: 3 • ROOMS: 22

▼ 2nd Floor

TOTAL AREA: 43.30 m² • LIVING AREA: 43.30 m² • ROOMS: 3

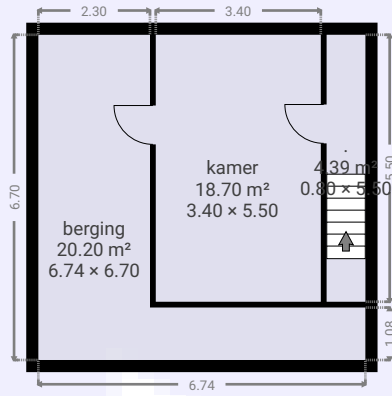

THIS FLOORPLAN IS PROVIDED WITHOUT WARRANTY OF ANY KIND. SENSOPIA DISCLAIMS ANY WARRANTY INCLUDING, WITHOUT LIMITATION, SATISFACTORY QUALITY OR ACCURACY OF DIMENSIONS.

0 2 4 6m

1:156
Page 2/2